

DÜZENLEME SINIR KROKİSİ

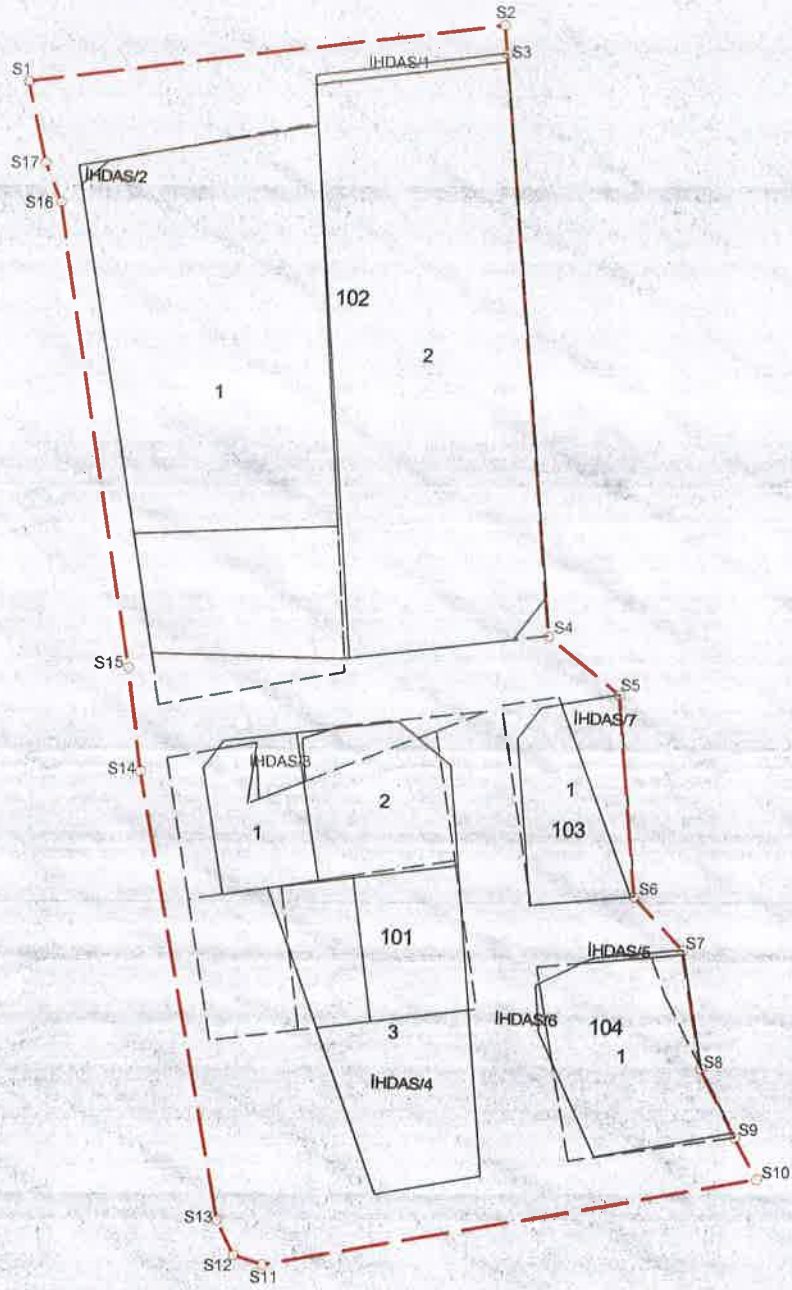

DÜZENLEME SINIRI KOORDİNE ÖZETİ (ITRF)

Nokta No:	Y	X
S1	539534.18	4401854.98
S2	539603.49	4401863.44
S3	539603.85	4401859.26
S4	539610.10	4401774.62
S5	539620.36	4401766.09
S6	539622.54	4401730.69
S7	539629.65	4401728.99
S8	539632.21	4401711.80
S9	539637.21	4401701.79
S10	539640.38	4401695.77
S11	539668.78	4401693.19
S12	539664.61	4401694.60
S13	539662.16	4401689.68
S14	539650.84	4401754.80
S15	539549.01	4401769.62
S16	539538.98	4401837.49
S17	539536.68	4401843.19

--- DÜZENLEME SINIRI

TOPLAM ALAN : 8156.09
 TOPLAM PAY : 8156.09
 TOPLAM KAMU LAŞTIRMA : 0.00
 TOP. DÜZENLE. GİRMEYEN: 0.00
 TOP. DÜZENLEMİYEBİREN: 7546.26

T E S C İ L E E S A S
 D A Ğ İ T İ M C E T V E L İ
 (İ M A R P A R S E L İ N E S İ R A L I)

SAYFA NO:1
 TOPLAM ALANI : 7546.26
 OKATILIM ORANI : 0.0000000
 D.O.PAYI ORANI : 0.0000000

SNo	Pafta	K A D A S T R O				I M A R				
		Alan	Hisse	Malik/Baba Adı	Kamu	Dop/Th	Ada/Par	Alan	Hisse	Pay
106	100/4	464.89	TAM 464.89	ODUNPAZARİBELEDİYESİ	-	118.04	101/1	304.16	11804/30416	118.04
36	7590/3	223.00	11/26 94.35	SAHİN ÇETİNKAYA RAİF	-	94.35	-	-	6808/30416	68.08
47	7590/4	279.00	11/26 118.04	SAHİN ÇETİNKAYA RAİF	-	118.04	-	-	11804/30416	118.04
60	7589/4	708.42	117569/244489 340.72	ODUNPAZARİBELEDİYESİ	-	340.72	101/2	438.83	6877/43883	68.77
4	7590/1	684.00	3/104 19.74	AHMETŞANAN HÜSEYİN	-	19.74	-	-	1115/43883	11.15
5	7590/1	684.00	3/26 78.92	EMİNE DAKNI İSMAIL	-	78.92	-	-	4458/43883	44.58
6	7590/1	684.00	3/104 19.73	HÜSEYİN ŞANAN MEHMET	-	19.73	-	-	1114/43883	11.14
7	7590/1	684.00	9/208 29.60	İLAYDA KAYA BATIRAN MEHMETZEKİ	-	29.60	-	-	1672/43883	16.72
8	7590/1	684.00	9/208 29.60	İSMAIL REMZİ BATIRAN MEHMETZEKİ	-	29.60	-	-	1672/43883	16.72
9	7590/1	684.00	3/104 19.73	MEHMETŞANAN HÜSEYİN	-	19.73	-	-	1114/43883	11.14
10	7590/1	684.00	3/104 19.73	MELEHATDEMİR HÜSEYİN	-	19.73	-	-	1114/43883	11.14
11	7590/1	684.00	3/104 19.73	SABAHAHAT BATIRAN AHMETREMZİ	-	19.73	-	-	1114/43883	11.14
12	7590/1	684.00	3/26 78.92	SEBAHAHATBEYENİRSOY İSMAIL	-	78.92	-	-	4458/43883	44.58
13	7590/1	684.00	3/26 78.92	SEMRABATIRAN İSMAIL	-	78.92	-	-	4458/43883	44.58
2	15496/20	43.17	TAM 43.17	ODUNPAZARİBELEDİYESİ	-	43.17	-	-	4318/43883	43.18
3	15502/1	97.52	TAM 97.52	ODUNPAZARİBELEDİYESİ	-	97.52	-	-	9752/43883	97.52
1	15503/1	6.47	TAM 6.47	ODUNPAZARİBELEDİYESİ	-	6.47	-	-	647/43883	6.47
4	7590/1	684.00	3/104 19.74	AHMETŞANAN HÜSEYİN	-	19.74	101/3	990.71	859/99071	8.59
5	7590/1	684.00	3/26 78.92	EMİNE DAKNI İSMAIL	-	78.92	-	-	3434/99071	34.34
6	7590/1	684.00	3/104 19.73	HÜSEYİN ŞANAN MEHMET	-	19.73	-	-	859/99071	8.59
7	7590/1	684.00	9/208 29.60	İLAYDA KAYA BATIRAN MEHMETZEKİ	-	29.60	-	-	1288/99071	12.88
8	7590/1	684.00	9/208 29.60	İSMAIL REMZİ BATIRAN MEHMETZEKİ	-	29.60	-	-	1288/99071	12.88
9	7590/1	684.00	3/104 19.73	MEHMETŞANAN HÜSEYİN	-	19.73	-	-	859/99071	8.59
10	7590/1	684.00	3/104 19.73	MELEHATDEMİR HÜSEYİN	-	19.73	-	-	859/99071	8.59

TOPLAMALAN : 8156.09		T E S C İ L E E S A S		SAYFA NO:2							
TOPLAMPAY : 8156.09		D A Ğ I T İ M C E T V E L İ		TOPLAMADA ALANI : 7546.26							
TOPLAMKAMULAŞTIRMA : 0.00		(İ M A R P A R S E L İ N E S İ R A L I)		OKATILIM ORANI : 0.000000							
TOP. DÜZENLE GİRMEYEN: 0.00				DÖPİYİ ORANI : 0.000000							
TOP. DÜZENLEMİYEBİREN: 7546.26											
		K A D A S T R O		İ M A R							
SNo	Pafita	Adai/Par	Alan	Hisse	Mallık/Baba Adı	Kısmı	Dop/Th	Adai/Par	Alan	Hisse	Pay
11		7590/1	684.00	3/104	SABAHATBATIRAN					859/99071	8.59
12		7590/1	684.00	19.73	AHMETREMZİ		19.73			3434/99071	34.34
13		7590/1	684.00	3/26	SEBAHATBEYENİRSOY					3434/99071	34.34
15		7590/2	330.00	78.92	ISMAL		78.92			951/99071	9.51
16		7590/2	330.00	3/26	SEMRABATIRAN					3807/99071	38.07
17		7590/2	330.00	78.92	ISMAL		78.92			952/99071	9.52
18		7590/2	330.00	3/104	AHMETŞANAN					1428/99071	14.28
19		7590/2	330.00	9.51	HÜSEYİN					1428/99071	14.28
20		7590/2	330.00	3/26	EMİNE DAKNI					952/99071	9.52
21		7590/2	330.00	38.07	ISMAL		38.07			952/99071	9.52
22		7590/2	330.00	3/104	HÜSEYİN ŞANAN					1428/99071	14.28
23		7590/2	330.00	9.52	MEHMET					1428/99071	14.28
24		7590/2	330.00	9/208	İLAYDA KAYA BATIRAN		14.28			952/99071	9.52
26		7590/3	223.00	14.28	MEHMETZEKİ		14.28			952/99071	9.52
27		7590/3	223.00	9/208	ISMAL REMZİ BATIRAN		14.28			3808/99071	38.08
28		7590/3	223.00	14.28	MEHMETZEKİ		14.28			3808/99071	38.08
29		7590/3	223.00	9.52	MEHMETŞANAN					644/99071	6.44
30		7590/3	223.00	3/104	HÜSEYİN					2573/99071	25.73
31		7590/3	223.00	6.44	EMİNE DAKNI					643/99071	6.43
32		7590/3	223.00	3/26	ISMAL					643/99071	6.43
33		7590/3	223.00	25.73	HÜSEYİN ŞANAN		25.73			965/99071	9.65
34		7590/3	223.00	6.43	İLAYDA KAYA BATIRAN		6.43			965/99071	9.65
35		7590/3	223.00	9/208	MEHMETZEKİ					643/99071	6.43
36		7590/3	223.00	9.65	ISMAL REMZİ BATIRAN					643/99071	6.43
37		7590/4	279.00	9.65	MEHMETZEKİ					2573/99071	25.73
38		7590/4	279.00	3/104	MEHMETŞANAN					2573/99071	25.73
				3/26	HÜSEYİN					805/99071	8.05
				25.73	EMİNE DAKNI					3219/99071	32.19
				25.73	ISMAL						
				8.05	AHMET ŞANAN		8.05				
				3/26	HÜSEYİN						
				32.19	EMİNE DAKNI		32.19				

TOPLAMALAN : 8156.09		SAYFA NO:3									
TOPLAMPAY : 8156.09		TOPLAMADA ALANI : 7546.26									
TOPLAMKAMULAŞTIRMA : 0.00		OKATILIM ORANI : 0.0000000									
TOP. DÜZENLE GİRMEYEN: 0.00		D.O.PAYI ORANI : 0.0000000									
TOP. DÜZENLEMİYEGİREN: 7546.26											
T E S C İ L E N E S A S											
D A Ğ İ T İ M C E T V E L İ											
(İ M A R P A R S E L İ N E S İ R A L İ)											
K A D A S T R O		M A R									
SNo	Pafita	AdarPar	Alan	Hisse	Malik/Baba Adı	Kamu	Daha/Th	AdarPar	Alan	Hisse	Pay
39		7590/4	279.00	3/104	HÜSEYİN ŞANAN		8.05			805/99071	8.05
40		7590/4	279.00	8.05	MERHET		12.07			1207/99071	12.07
41		7590/4	279.00	9/208	LAYDA KAYA BATIRAN		12.07			1207/99071	12.07
42		7590/4	279.00	12.07	MEHMETZEKİ		8.05			805/99071	8.05
43		7590/4	279.00	3/104	ISMAIL REMZİ BATIRAN		8.05			805/99071	8.05
44		7590/4	279.00	3/104	MEHMETZEKİ		8.05			805/99071	8.05
45		7590/4	279.00	3/26	MEHMETŞANAN		32.19			3219/99071	32.19
46		7590/4	279.00	3/26	HÜSEYİN		32.19			3219/99071	32.19
48		7591/1	339.00	1/20	MELAHATDEMİR		16.96			1696/99071	16.96
49		7591/1	339.00	1/5	HÜSEYİN		67.80			6780/99071	67.80
50		7591/1	339.00	1/20	EMİNE DAKNI		16.95			1695/99071	16.95
51		7591/1	339.00	3/40	HÜSEYİN ŞANAN		25.42			2542/99071	25.42
52		7591/1	339.00	3/40	MEHMET		25.42			2542/99071	25.42
53		7591/1	339.00	1/20	LAYDA KAYA BATIRAN		16.95			1695/99071	16.95
54		7591/1	339.00	1/20	MEHMETZEKİ		16.95			1695/99071	16.95
55		7591/1	339.00	1/20	ISMAIL REMZİ BATIRAN		16.95			1695/99071	16.95
56		7591/1	339.00	1/5	MEHMETZEKİ		67.80			6780/99071	67.80
57		7591/1	339.00	1/5	MEHMETŞANAN		67.80			6780/99071	67.80
59		7589/4	708.42	126900/244489	HÜSEYİN		1021		2375.62	36770/237562	367.70
60		7589/4	708.42	367.70	ADEMBÜDÜK		367.70		27195/237562	27195/237562	271.95
61		7589/5	1735.97	117588/244489	BULDUK		340.72		83493/237562	83493/237562	834.93
62		7589/5	1735.97	834.93	ODUNPAZARİBELEDİYESİ		834.93		90104/237562	90104/237562	901.04
63		15501/1	2423.67	1/12	ADEMBÜDÜK		1022		2423.67	201972/42367	201.97
64		15501/1	2423.67	201.97	BULDUK		201.97		201972/42367	201972/42367	201.97

TOPLAMALAN : 8156.09 TOPLAMPAY : 8156.09 TOPLAMKAMULAŞTIRMA : 0.00 TOP. DÜZENLE. GİRMEYEN: 0.00 TOP. DÜZENLEMEYEBİREN: 7546.26				TEŞCİLE ESAS DAĞITIM CETVELİ (İMAR PARSELİNE SIRA...)				SAYFA NO:4 TOPLAMADA ALANI : 7546.26 OKATILIM ORANI : 0.000000 D.O.PAYI ORANI : 0.000000			
K A D A S T R O				M I A R							
SNo	Pafta	Ada/Par	Alan	Hisse	Malik/Baba Adı	Kamu	Dop/Th	Ada/Par	Alan	Hisse	Pay
65	15501/1	2423.67	112	AHMET TOPÇU		201.97	201.97	20197/242367	201.97	201.97	201.97
66	15501/1	2423.67	1/12	MEHMET İHSAN ÇELİK		201.97	201.97	20197/242367	201.97	201.97	201.97
67	15501/1	2423.67	1/12	SALİH ERSİN YILMAZ		201.98	201.98	20198/242367	201.98	201.98	201.98
68	15501/1	2423.67	1/12	AHMET YUSUF AKGÖN		201.98	201.98	20198/242367	201.98	201.98	201.98
69	15501/1	2423.67	1/12	İSMAIL AHMET DÖNMEZ		201.98	201.98	20198/242367	201.98	201.98	201.98
70	15501/1	2423.67	1/12	ÖMER HATİCE KOCA		201.97	201.97	20197/242367	201.97	201.97	201.97
71	15501/1	2423.67	1/12	MAHMUT AHMET ÇİFTÇİ		201.97	201.97	20197/242367	201.97	201.97	201.97
72	15501/1	2423.67	1/12	HALİL İBRAHİM AKİF YETİM		201.97	201.97	20197/242367	201.97	201.97	201.97
73	15501/1	2423.67	1/12	ALİ OSMANALDEMİR		201.97	201.97	20197/242367	201.97	201.97	201.97
74	15501/1	2423.67	1/12	H İBRAHİM NURTENMEMİŞ		201.97	201.97	20197/242367	201.97	201.97	201.97
14	7590/1	684.00	11/26	ŞAHİN ÇETİNKAYA		103/1	103/1	26507/43096	430.96	265.07	265.07
25	7590/2	330.00	288.38	RAİF SAHİN ÇETİNKAYA		288.38	288.38	13962/43096	139.62	139.62	139.62
36	7590/3	223.00	136.62	RAİF SAHİN ÇETİNKAYA		136.62	136.62	2627/43096	26.27	26.27	26.27
14	7590/1	684.00	94.35	RAİF SAHİN ÇETİNKAYA		94.35	94.35	2431/58231	582.31	24.31	24.31
58	7592/1	558.00	11/26	RAİF SAHİN ÇETİNKAYA		288.38	288.38	55800/58231	558.00	558.00	558.00
			558.00	TAM		558.00	558.00				